

How to determine the sectors of your home?

The determination of home sectors is not complicated but many disputes on such topics have been discussed by various Feng Shui schools. I will combine the scientific approach for better comprehension of both contemporary as well as ancient approaches.

In Chinese the word '立極' or 'Lap Kek' is used to determine the center point of a home, this word literally means that *to determine the tai chi of an area*. We can have a big or general tai chi that includes garden and your home gross area. The use of such is general in application. Alternatively, we will use the practical tai chi that includes the total gross construction area only.

The Practical Tai Chi Determination (Focal Point)

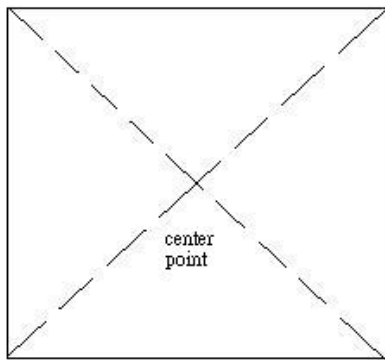

To align all corners to get 4-directions.

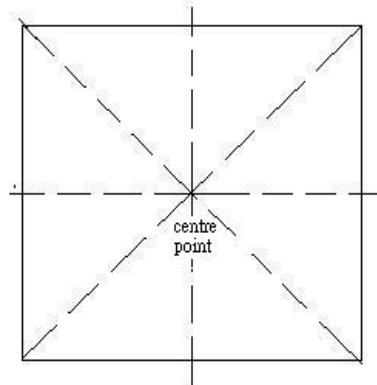

To divide the sectors further to 8-directions.

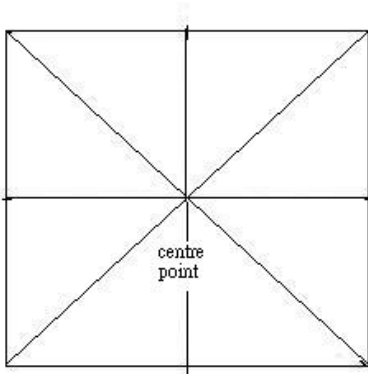

(N, NE, E, SE, S, SW, W, NW)

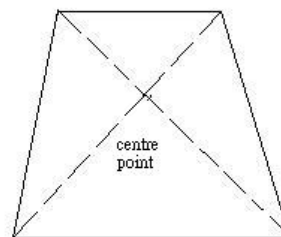

Different shape focal point

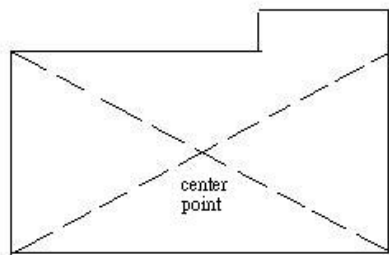

Additional sector focal point

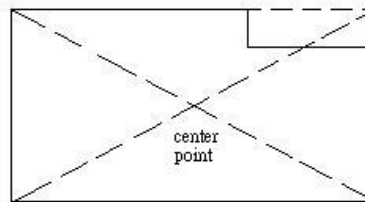

Different shape focal point

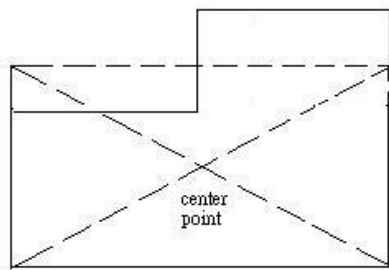

Different shape focal point

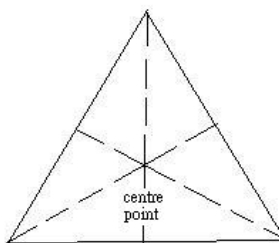

Different shape focal point

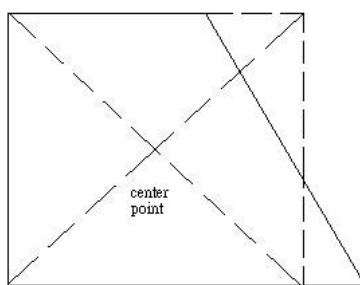

Different shape focal point



Example of a focal point

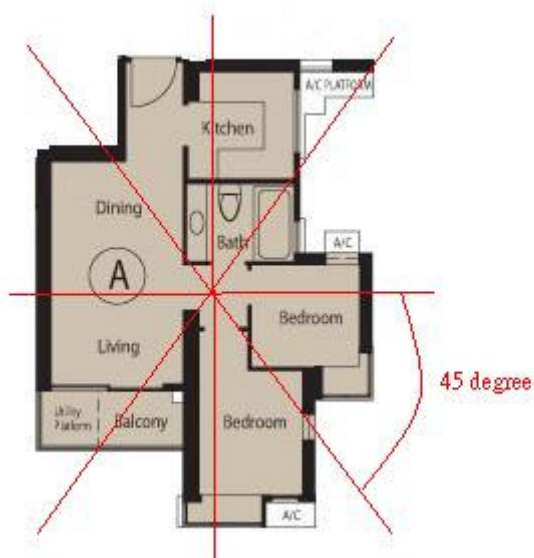

Example of a focal point